

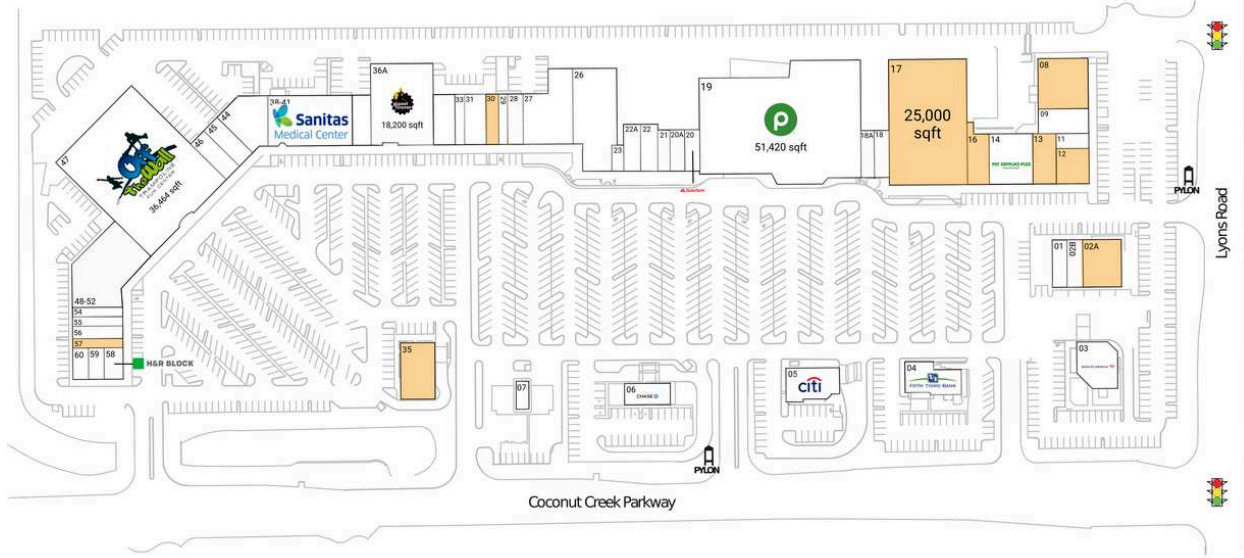

# Coconut Creek Plaza



01 Edward Jones	1,535 SF	<b>16 AVAILABLE</b>	2,800 SF
<b>02A AVAILABLE</b>	4,000 SF	<b>17 AVAILABLE</b>	25,000 SF
02B Profile by Sanford	2,500 SF	18 Diva Nail Bar	1,740 SF
03 Bank of America	3,900 SF	18A Publix Liquor	1,973 SF
04 Fifth Third Bank	3,275 SF	19 Publix	51,420 SF
05 Citi	4,235 SF	20 State Farm	1,412 SF
06 Chase	2,483 SF	20A Johnny Pies	1,155 SF
07 BP Products North America, Inc	3,522 SF	21 Hair Cuttery	1,050 SF
<b>08 AVAILABLE</b>	5,824 SF	22 Chase Nails	1,975 SF
09 Laundromart	3,112 SF	22A Golden Krust	1,834 SF
11 Cosmetic & Implant Designs Group	1,250 SF	23 Tarrazu Coffee Co	1,157 SF
<b>12 AVAILABLE</b>	3,000 SF	26 Faith World Harvest Church	10,300 SF
<b>13 AVAILABLE</b>	2,550 SF	27 Ballet Elite	8,000 SF
14 Pet Supplies Plus	6,370 SF	28 La Rural Mexican Grill	2,000 SF

# Coconut Creek Plaza

---

29 Coconut Creek Podiatry Assoc.	1,136 SF	47 Off the Wall Trampoline	36,464 SF
<b>30 AVAILABLE</b>	1,600 SF	48-52 Career Source of Broward	10,365 SF
31 Back In Motion Physical Therapy	2,050 SF	54 Ronel Desrosiers	1,200 SF
33 Lifestyle Hearing of Broward	1,200 SF	55 A-1 Master Traffic & Driving School	1,200 SF
<b>35 AVAILABLE</b>	4,783 SF	56 J&J Ship and Print	1,600 SF
36A Planet Fitness	18,200 SF	<b>57 AVAILABLE</b>	1,250 SF
38-41 Sanitas Medical Center	10,800 SF	58 H&R Block	1,500 SF
44 Coconut Creek Academy	4,892 SF	59 Estrella Insurance	1,250 SF
45 Dental First Care	2,400 SF	60 Puppylicious Grooming Spa	1,250 SF
46 Cloak & Dagger Escape Rooms	2,400 SF		