

# Collegeville Shopping Center

Philadelphia-Camden-Wilmington, PA-NJ-DE-MD

40.1833, -75.4515

222 East Main Street | Collegeville, PA 19426



**Center Size:** 101,630 SF



Demographics	1 Mile	3 Mile	5 Mile
	8,283	41,899	117,826
	2,732	13,542	42,686
	\$167,290	\$184,622	\$161,476

Strong lineup of regional and national retailers including Kimberton Whole Foods, Planet Fitness & Club Pilates

Surrounded by an affluent and highly educated population with an average household income of \$184K+ and 55% college educated within a 3-mile radius

Located less than a mile from Ursinus College with an enrollment of 1,400+ students (NCES, 2023)

High visibility from 18K+ VPD on 2nd Ave and 25K+ VPD on E Main St (Kalibrate, 2019)

# Collegeville Shopping Center

Philadelphia-Camden-Wilmington, PA-NJ-DE-MD

40.1833, -75.4515

222 East Main Street | Collegeville, PA 19426

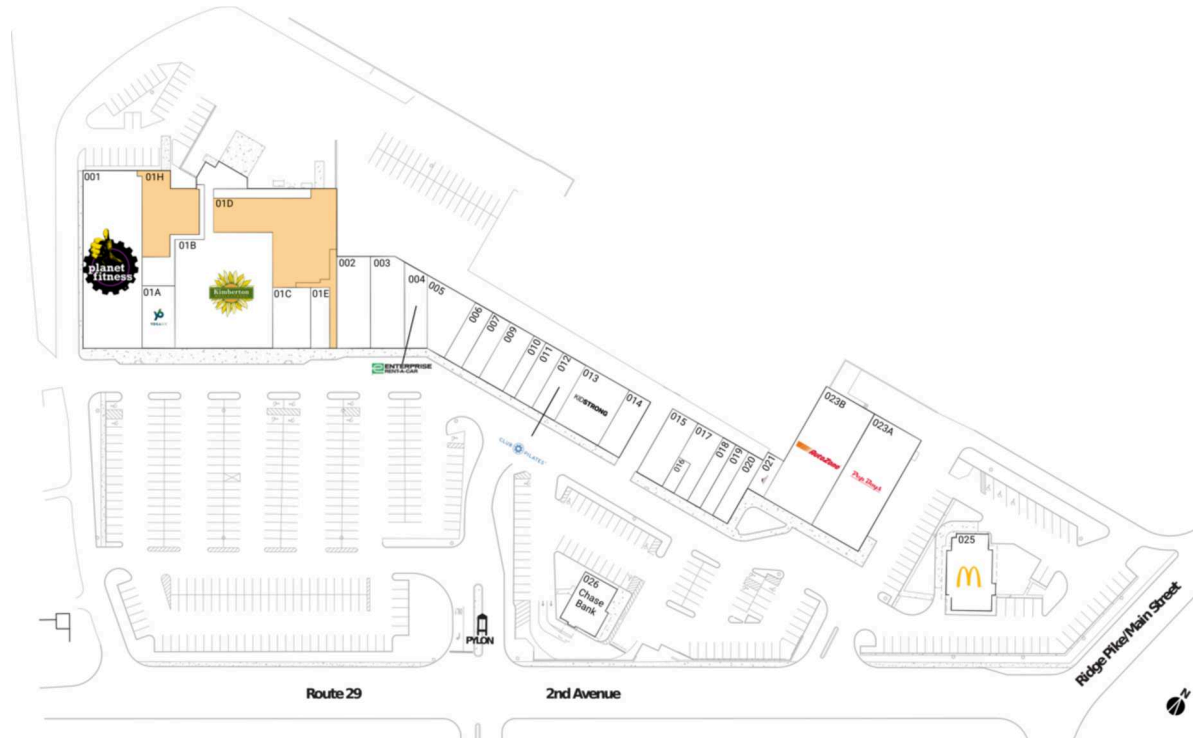

## Available Space

01D	9,198 SF
01H	4,463 SF

## Current Retailers

001	Planet Fitness	12,183 SF
01A	YogaSix	2,520 SF
01B	Kimberton Whole Foods	15,047 SF
01C	The Dental Spot	2,682 SF
01E	The Lash Lounge	1,400 SF
002	Leslie's Pool Supplies	3,721 SF
003	Fred Astaire Dance Studio	3,767 SF
004	Enterprise-Rent-A-Car	2,200 SF
005	Goodness Bowls	2,663 SF
006	Great Wall Chinese Restaurant	1,540 SF
007	Bella Persone Salon	1,540 SF
009	Dana's Cafe	2,100 SF
010	Collegeville Nails	1,050 SF
011	The Eye Shoppe	1,540 SF
012	Club Pilates	1,994 SF
013	KidStrong	3,861 SF
014	Wireless Zone	1,874 SF
015	The Pizza Stop	2,560 SF
016	Stagliano Barber Shop	560 SF
017	beem™ Light Sauna	2,000 SF
018	Rita's Italian Ice	1,280 SF
019	Chiccarine's Fine Jewelry	1,280 SF
020	Philly's Pretzel Factory	1,400 SF
021	CBD American Shaman	900 SF
023A	Pep Boys	8,000 SF
023B	AutoZone	8,000 SF
025	McDonald's	2,000 SF
026	Chase Bank	2,400 SF

4019