

Collegeville Shopping Center

Philadelphia-Camden-Wilmington, PA-NJ-DE-MD

40.1833, -75.4515

222 East Main Street | Collegeville, PA 19426



Center Size: 101,630 SF



| Demographics | 1 Mile | 3 Mile | 5 Mile |
|--------------|-----------|-----------|-----------|
| | 8,283 | 41,899 | 117,826 |
| | 2,732 | 13,542 | 42,686 |
| | \$167,290 | \$184,622 | \$161,476 |

Strong lineup of regional and national retailers including Kimberton Whole Foods, Planet Fitness & Club Pilates

Surrounded by an affluent and highly educated population with an average household income of \$184K+ and 55% college educated within a 3-mile radius

Located less than a mile from Ursinus College with an enrollment of 1,400+ students (NCES, 2023)

High visibility from 18K+ VPD on 2nd Ave and 25K+ VPD on E Main St (Kalibrate, 2019)

Collegeville Shopping Center

Philadelphia-Camden-Wilmington, PA-NJ-DE-MD

40.1833, -75.4515
222 East Main Street | Collegeville, PA 19426

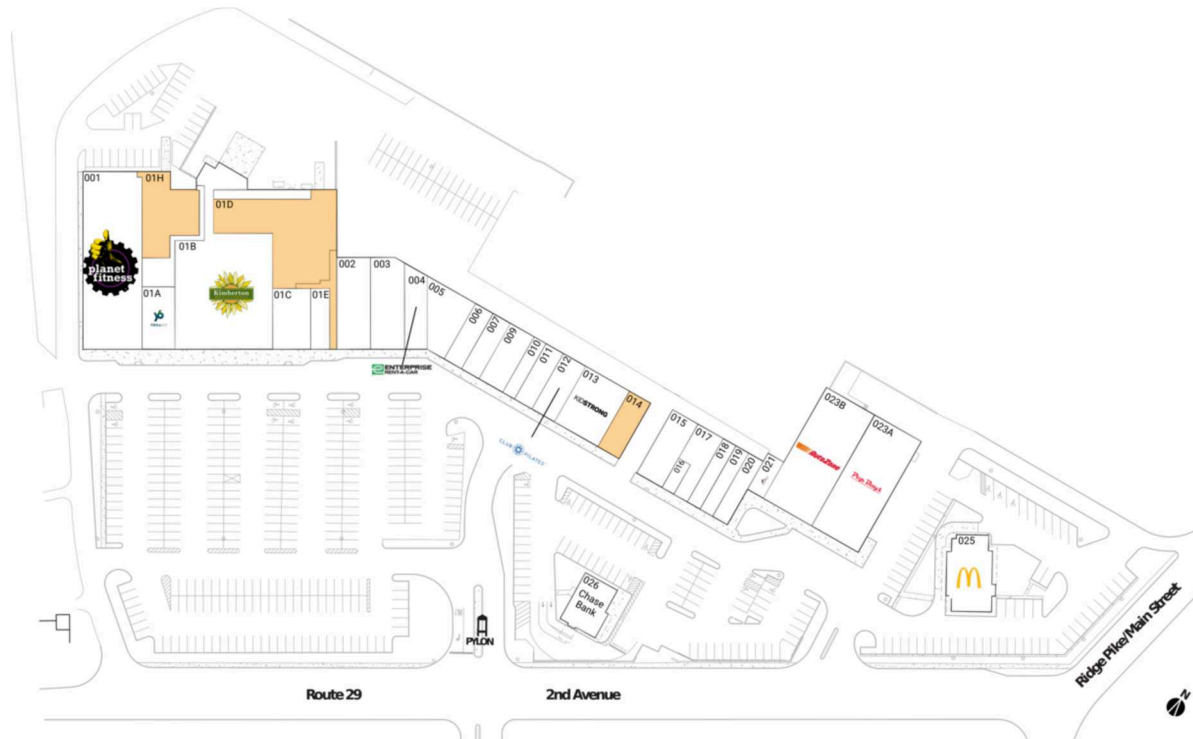

Available Space

| | |
|-----|----------|
| 01D | 9,198 SF |
| 01H | 4,463 SF |
| 014 | 1,874 SF |

Current Retailers

| | | |
|------|-------------------------------|-----------|
| 001 | Planet Fitness | 12,183 SF |
| 01A | YogaSix | 2,520 SF |
| 01B | Kimberton Whole Foods | 15,047 SF |
| 01C | The Dental Spot | 2,682 SF |
| 01E | The Lash Lounge | 1,400 SF |
| 002 | Leslie's Pool Supplies | 3,721 SF |
| 003 | Fred Astaire Dance Studio | 3,767 SF |
| 004 | Enterprise-Rent-A-Car | 2,200 SF |
| 005 | Goodness Bowls | 2,663 SF |
| 006 | Great Wall Chinese Restaurant | 1,540 SF |
| 007 | Bella Persone Salon | 1,540 SF |
| 009 | Dana's Cafe | 2,100 SF |
| 010 | Collegeville Nails | 1,050 SF |
| 011 | The Eye Shoppe | 1,540 SF |
| 012 | Club Pilates | 1,994 SF |
| 013 | KidStrong | 3,861 SF |
| 015 | The Pizza Stop | 2,560 SF |
| 016 | Stagliano Barber Shop | 560 SF |
| 017 | beem™ Light Sauna | 2,000 SF |
| 018 | Rita's Italian Ice | 1,280 SF |
| 019 | Chiccarine's Fine Jewelry | 1,280 SF |
| 020 | Philly's Pretzel Factory | 1,400 SF |
| 021 | CBD American Shaman | 900 SF |
| 023A | Pep Boys | 8,000 SF |
| 023B | AutoZone | 8,000 SF |
| 025 | McDonald's | 2,000 SF |
| 026 | Chase Bank | 2,400 SF |

4019