

# McMullen Creek Market

Charlotte-Concord-Gastonia, NC-SC

35.0892, -80.8595  
8318 Pineville-Matthews Rd | Charlotte, NC 28226



**Center Size:** 284,224 SF



Demographics	1 Mile	3 Mile	5 Mile
👤	12,497	74,626	200,442
🏠	5,699	32,805	82,569
💰	\$91,469	\$120,568	\$130,44

Walmart Neighborhood Market-anchored shopping center with a strong lineup of national retailers including Burlington Stores, Dollar Tree, Spectrum & Staples, drawing an estimated 6,800 visits/day and 2.5M+ visits/year (based on Placer.ai)

Retail location on Pineville-Matthews Rd in the middle of South Charlotte's retail hub with nearly 800,000 SF of retail space.

Close proximity to Carolina Place Mall with 14MM+ visitors/year.

Surrounded by an affluent population of 74,000+ with an average household income of \$120,000+ within a 3-mile radius.

Charlotte is the second largest banking and financial market in the U.S.

Property is currently under renovation

# McMullen Creek Market

Charlotte-Concord-Gastonia, NC-SC

35.0892, -80.8595  
8318 Pineville-Matthews Rd | Charlotte, NC 28226



### Available Space

0013	1,735 SF
0017	2,000 SF
0032	1,903 SF
0040	1,190 SF
0041	1,190 SF

### Pad Opportunities

PAD A Drive-thru	10,000 SF/0.2
PAD B Pad	0 SF/0

### Current Retailers

ATM	Bank of America	0 SF	0026	Salon Plaza	6,176 SF
	ATM		28/29	Staples	12,729 SF
N.A.P.	Chili's Grill & Bar	0 SF	30/30B	Walmart	45,005 SF
N.A.P.1	Speedy Lube	0 SF		Neighborhood Market	
N.A.P.2	Waffle House	0 SF		Kure	2,000 SF
0001	Dunkin' Donuts & Baskin Robbins	4,283 SF	0031	Los Paisas	2,000 SF
0002	The UPS Store	1,137 SF	0033	Restaurant	
0003	Hungry Howie's	1,800 SF	0035	Bonchon	2,820 SF
0004	Wingstop	1,800 SF	0036	Dog Gone Beautiful	1,080 SF
0005	U.S. Bank	1,800 SF		Stylash Spa	580 SF
0005A	Rio Body Wax	1,800 SF	0037	Huntington	2,400 SF
0006	Mr. Tokyo Japanese Restaurant	2,610 SF	0037B	Learning Center	
			0038	704 Korean BBQ	4,999 SF
0006A	Metro Diner	4,463 SF	0039	Dolce Casa Tile	630 SF
0008	Spectrum	5,400 SF		Boutique	
0009	IORA Health	6,200 SF	0042	Bloomingnails	1,341 SF
0011A	Dollar Tree	12,905 SF	0043	Any Lab Test Now	1,080 SF
0011B	pOpshelf	12,922 SF	0044	Charlotte Driving Academy	1,955 SF
0012	Smile Right Dental	2,140 SF	0045	Tower Place	905 SF
12A	The Skrimp Shack	2,540 SF		Barber Shop	
0014	Quick Wok	1,335 SF	0046	Fast Frame	1,430 SF
0015	Cigarettes & More	1,760 SF	0047	Milan Laser Hair Removal	1,644 SF
0016	The Soccer Shop	4,000 SF	0048	Whole Pet Vet	2,834 SF
18/19	Lebo's	6,080 SF	0050	Chiropractic Fitness	1,974 SF
0021	Compleat Rehab	1,966 SF	0051	Rice & Spice	3,122 SF
0022	United States Post Office	5,600 SF	0052	Salon Centric	3,217 SF
0023	Fit to Fight Charlotte	2,400 SF	54&55	Soap Suds	2,844 SF
0024	Salon Le Thomas	2,000 SF		Laundry/Cleaners	
0025	Anna's Alterations	2,432 SF	0056	Burlington	53,166 SF

# McMullen Creek Market

Charlotte-Concord-Gastonia, NC-SC

35.0892, -80.8595  
8318 Pineville-Matthews Rd | Charlotte, NC 28226

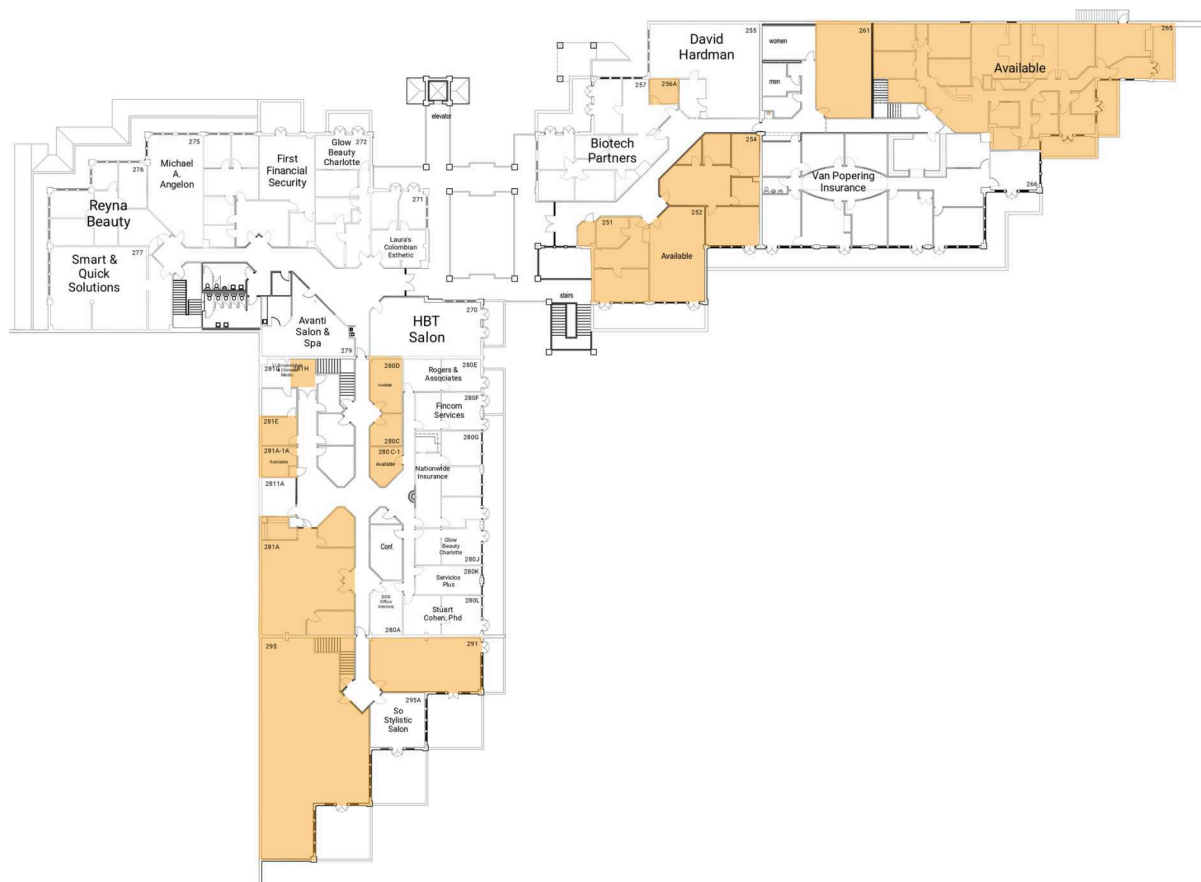

## Available Space

251	705 SF
252	705 SF
254	1,249 SF
256A	120 SF
261	325 SF
265	5,287 SF
280 C-1	160 SF
280C	289 SF
280D	252 SF
281A	1,520 SF
281A-1A	124 SF
281E	213 SF
281H	162 SF
291	849 SF
295	2,833 SF

## Current Retailers

255	David Hardman	969 SF
257	Biotech Partners	1,157 SF
266	Van Popering Insurance	3,847 SF
270	HBT Salon	932 SF
271	Laura's Colombian Esthetic	622 SF
272	Glow Beauty Charlotte	345 SF
273	First Financial Security	1,760 SF
275	Michael A. Angelon	777 SF
276	Reyna Beauty	1,110 SF
277	Smart & Quick Solutions	1,432 SF
279	Avanti Salon & Spa	763 SF
280A	DOD Office Interiors	252 SF
280E	Rogers & Associates	360 SF
280F	Fincom Services	348 SF
280G	Nationwide Insurance	897 SF
280J	Glow Beauty Charlotte	345 SF
280K	Servicios Plus	274 SF
280L	Stuart Cohen, Phd	477 SF
281G	LI Acupuncture & Chinese Medic	162 SF
295A	So Stylistic Salon	500 SF
2811A	Suzano Pulp and Paper	175 SF

4129