

# Elmhurst Crossing

Chicago-Naperville-Elgin, IL-IN

41.893, -87.9611

NEC Route 83 and St. Charles Road | Elmhurst, IL 60126

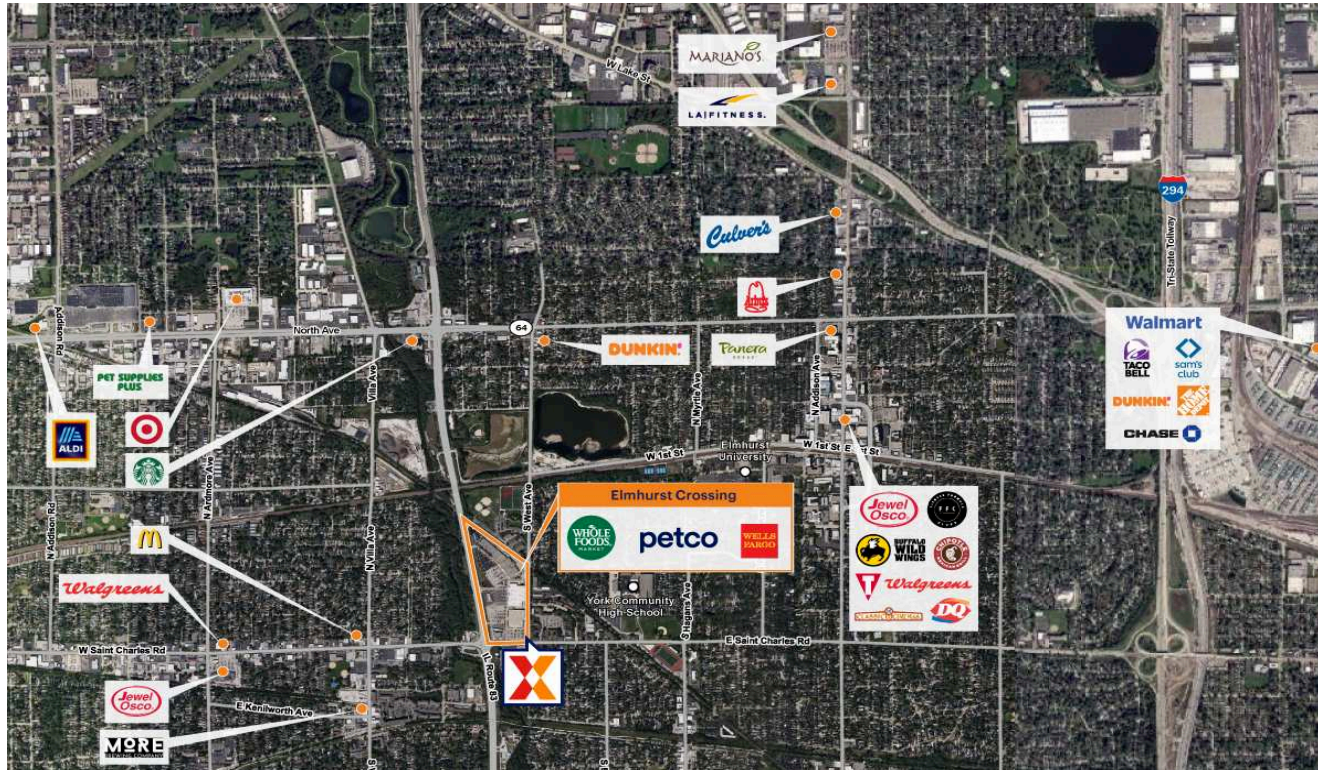

**Center Size:** 347,503 SF



Demographics	1 Mile	3 Mile	5 Mile
	14,969	115,225	279,345
	5,641	41,835	102,185
	\$181,548	\$147,323	\$125,148

Whole Foods Market-anchored community shopping center with top national brands such as Five Below, Kohl's & Shoe Carnival, drawing an estimated 12K+ visits daily and 4.4M+ annually (Placer.ai 2024)

Surrounded by a highly educated, affluent and dense in-fill trade area with 115K+ residents, with average household incomes of \$147K+ and 46% holding college degrees within 3 miles

Strong daytime population with 144K+ within 3 miles

Excellent visibility from 57K+ vehicles daily on Robert Kingery Hwy/IL Rte 83 and 18K+ on W St Charles Rd, providing regional access to I-290 and I-88 (Kalibrate 2022)

The trade area is served by the regional commuter rail provider Metra's Union Pacific West Line with service to Union Station in downtown Chicago

# Elmhurst Crossing

Chicago-Naperville-Elgin, IL-IN

41.893, -87.9611

NEC Route 83 and St. Charles Road | Elmhurst, IL 60126

## Available Space

OPO 1	0 SF
359	2,457 SF

## Current Retailers

155	Portillo's	7,145 SF
161	Hallmark	4,800 SF
167	Pure Hockey	8,000 SF
171	Bath & Body Works	3,200 SF
177	uBREAKiFIX	1,575 SF
179	Huntington Learning Center	1,785 SF
181	Luxury Nail Salon	1,891 SF
183	LaserAway	1,600 SF
185	Hair Cuttery	1,575 SF
187	Orangetheory Fitness	4,800 SF
191	Massage Envy	4,463 SF
195	Shoe Carnival	13,200 SF
201	Petco	15,120 SF
209	Five Below	12,104 SF
215	Whole Foods Market	51,179 SF
235	Chick-fil-A	4,927 SF
265	At Home	103,015 SF
299	America's Best Contacts & Eyeglasses	3,000 SF
301	PT Solutions Physical Therapy	2,400 SF
303	Kohl's	86,584 SF
333	Wells Fargo	4,589 SF
353	Chipotle Mexican Grill	2,364 SF
355	Nothing Bundt Cakes	1,817 SF
357	European Wax Center	1,722 SF
361	T-Mobile	2,193 SF

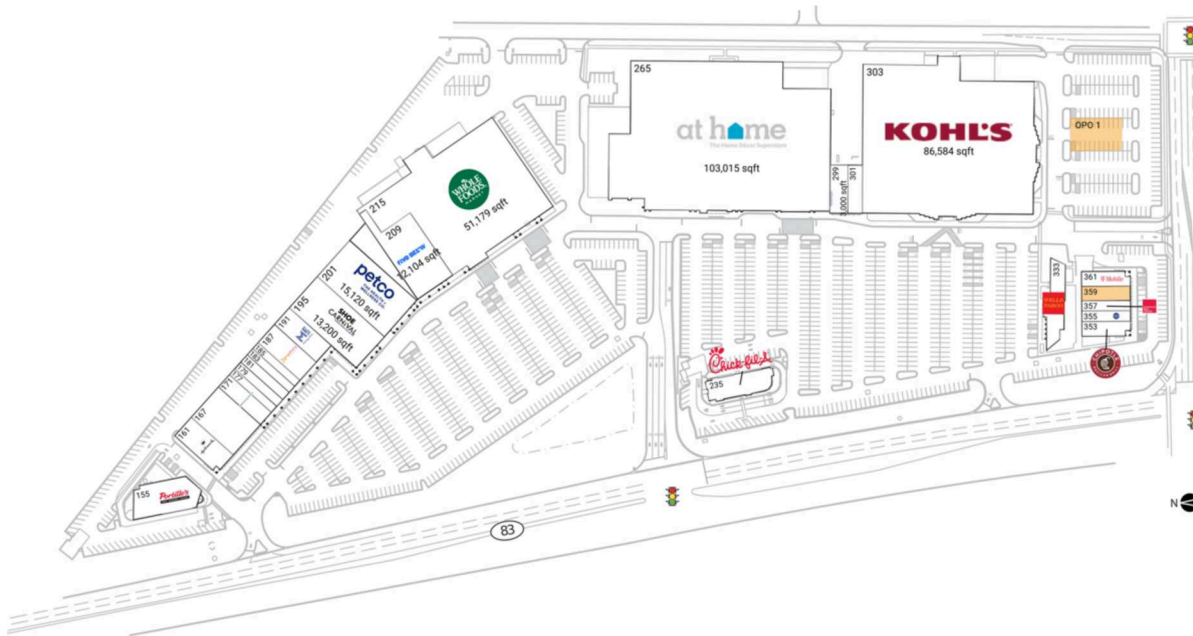

1773