

McMullen Creek Market

Charlotte-Concord-Gastonia, NC-SC

35.0892, -80.8595
8318 Pineville-Matthews Rd | Charlotte, NC 28226



Available Space

0013	1,735 SF
0017	2,000 SF
0021	1,966 SF
0032	1,903 SF
0040	1,190 SF
0041	1,190 SF

Pad Opportunities

PAD A Drive-thru	10,000 SF/0.2
PAD B Pad	0 SF/0

Current Retailers

ATM	Bank Of America	0 SF	0026	Salon Plaza	6,176 SF
	ATM		28/29	Staples	12,729 SF
N.A.P.	Chili's Grill & Bar	0 SF	30/30B	Walmart	45,005 SF
N.A.P.1	Speedy Lube	0 SF		Neighborhood Market	
N.A.P.2	Waffle House	0 SF		Kure	2,000 SF
0001	Dunkin' Donuts & Baskin Robbins	4,283 SF	0031	Los Paisas	2,000 SF
0002	The UPS Store	1,137 SF	0033	Restaurant	
0003	Hungry Howie's	1,800 SF	0035	Bonchon	2,820 SF
0004	Wingstop	1,800 SF	0036	Dog Gone Beautiful	1,080 SF
0005	U.S. Bank	1,800 SF	0037	Stylash Spa	580 SF
0005A	Rio Body Wax	1,800 SF	0037B	Huntington	2,400 SF
0006	Mr. Tokyo Japanese Restaurant	2,610 SF	0038	Learning Center	
0006A	Metro Diner	4,463 SF	0042	704 Korean BBQ	4,999 SF
0008	Spectrum	5,400 SF	0043	Alo Nail Lounge	1,341 SF
0009	IORA Health	6,200 SF	0044	Any Lab Test Now	1,080 SF
0011A	Dollar Tree	12,905 SF	0044	Charlotte Driving Academy	1,955 SF
0011B	Popshelf	12,922 SF	0045	Tower Place Barber Shop	905 SF
0012	Smile Right Dental	2,140 SF	0046	Fast Frame	1,430 SF
12A	The Skrimp Shack	2,540 SF	0047	Milan Laser Hair Removal	1,644 SF
0014	Quick Wok	1,335 SF		Whole Pet Vet	2,834 SF
0015	Cigarettes & More	1,760 SF	0048	Chiropractic Fitness	1,974 SF
0016	The Soccer Shop	4,000 SF	0050	Rice & Spice	3,122 SF
18/19	Lebo's	6,080 SF	0051	Salon Centric	3,217 SF
0022	United States Post Office	5,600 SF	0052	Soap Suds Laundry/Cleaners	2,844 SF
0023	Fit To Fight Charlotte	2,400 SF	54&55	Burlington	53,166 SF
0024	Salon Le Thomas	2,000 SF	0056		
0025	Anna's Alterations	2,432 SF			

4129

McMullen Creek Market

Charlotte-Concord-Gastonia, NC-SC

35.0892, -80.8595
8318 Pineville-Matthews Rd | Charlotte, NC 28226

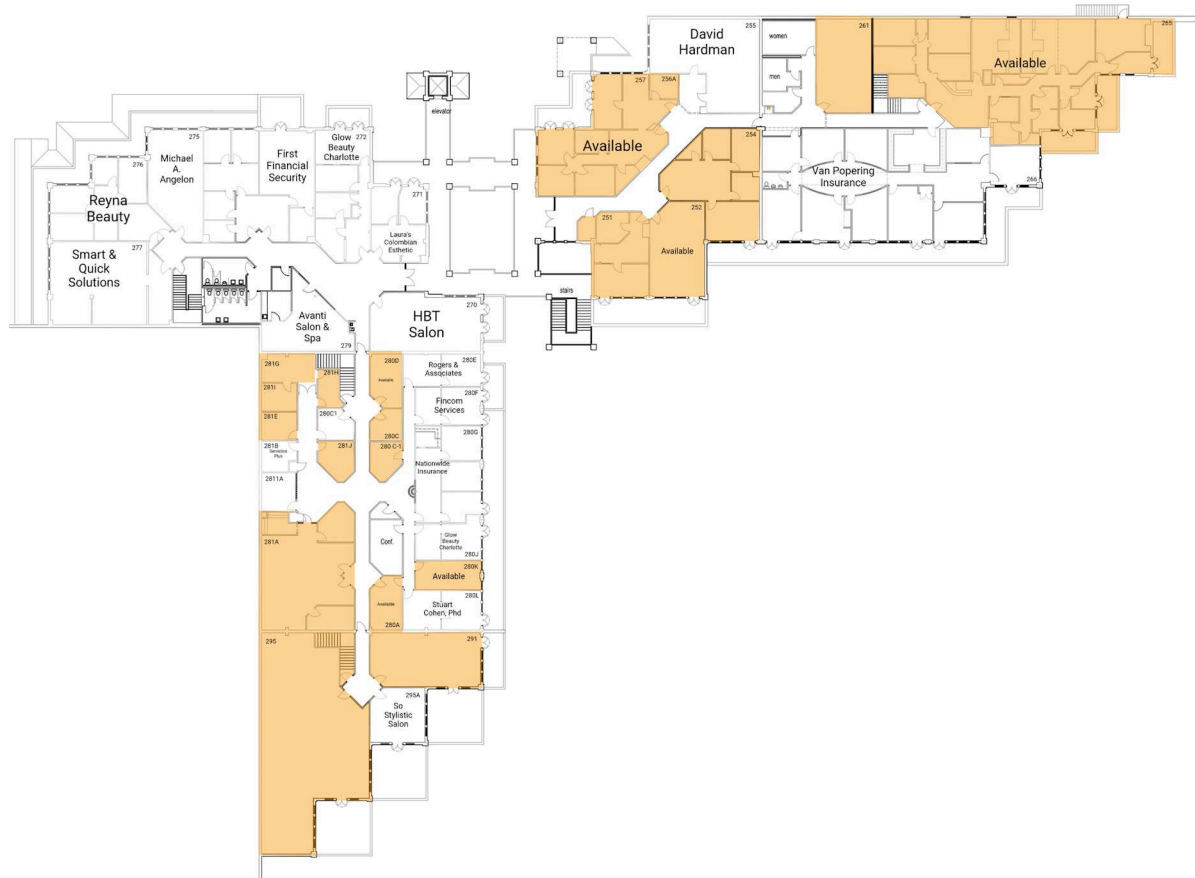

4129

Available Space

251	705 SF
252	705 SF
254	1,249 SF
256A	120 SF
257	1,157 SF
261	325 SF
265	5,287 SF
280 C-1	160 SF
280A	252 SF
280C	289 SF
280D	252 SF
280K	274 SF
281A	1,520 SF
281E	213 SF
281G	324 SF
281H	160 SF
281I	160 SF
281J	160 SF
291	849 SF
295	2,833 SF

Current Retailers

255	David Hardman	969 SF
266	Van Popering Insurance	3,847 SF
270	HBT Salon	932 SF
271	Laura's Colombian Esthetic	622 SF
272	Glow Beauty Charlotte	345 SF
273	First Financial Security	1,760 SF
275	Michael A. Angelon	777 SF
276	Reyna Beauty	1,110 SF
277	Smart & Quick Solutions	1,432 SF
279	Avanti Salon & Spa	763 SF
280C1	Skin 2 NV Facial & Waxing Studio	160 SF
280E	Rogers & Associates	360 SF
280F	Fincom Services	348 SF
280G	Nationwide Insurance	897 SF
280J	Glow Beauty Charlotte	345 SF
280L	Stuart Cohen, Phd	477 SF
281B	Servicios Plus	124 SF
295A	So Stylistic Salon	500 SF
2811A	Suzano Pulp And Paper	175 SF