

# Westridge Court

Chicago-Naperville-Elgin, IL-IN-WI

41.7653, -88.2027

204 South Route 59 | Naperville, IL 60540

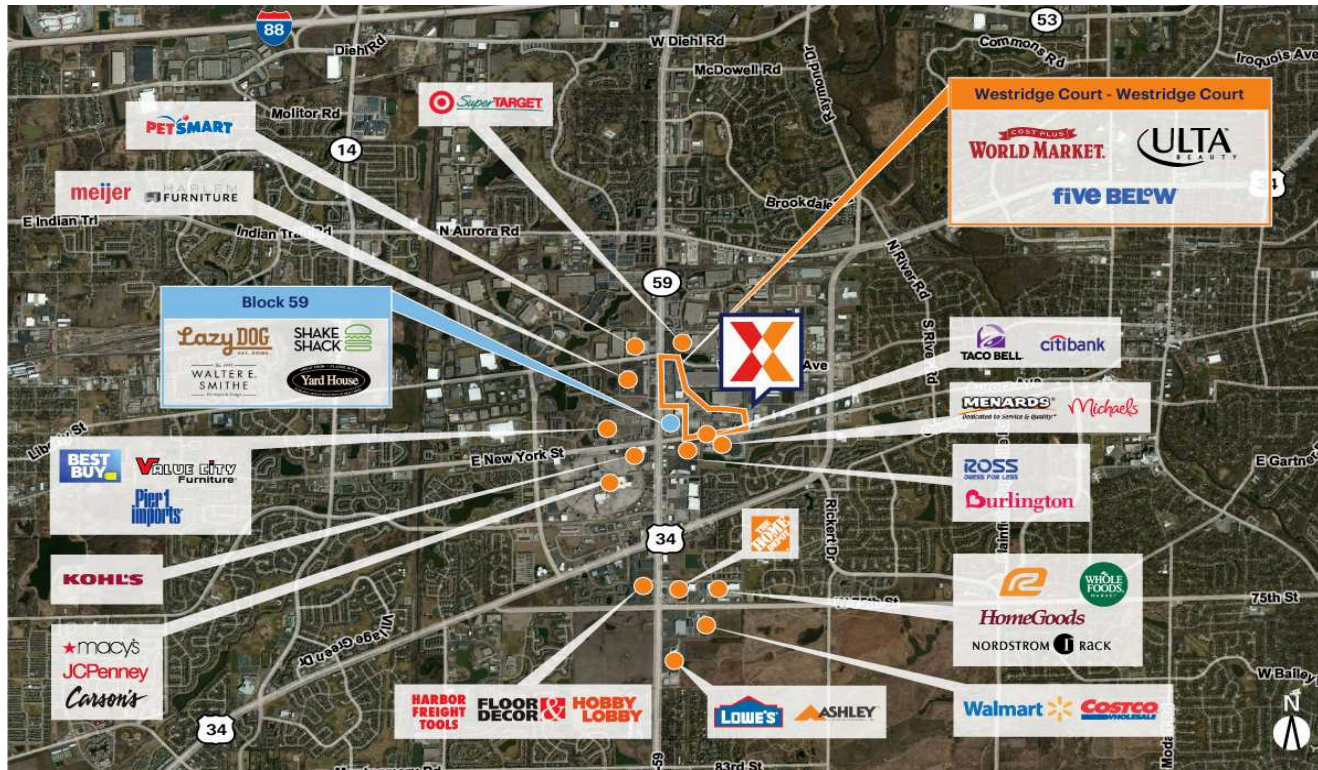

Center Size: 535,013 SF

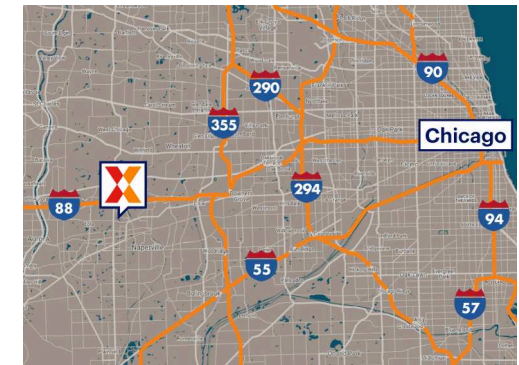

Demographics	1 Mile	3 Mile	5 Mile
	7,516	87,741	249,550
	3,013	33,408	88,916
	\$119,746	\$131,471	\$134,713

Prime location in Fox Valley regional retail market with 6MM SF of space

Surrounded by a dense population of 249,000+ with an average household income of \$134,000+ within a 5-mile radius

Recent renovations include modernized façades, repaved parking lots + sidewalks, and new monument signage

Features a diverse mix of national tenants including Five Below, Ulta, Painted Tree Marketplace, Cost Plus World Market, and La-Z-Boy, the center draws an estimated 10,800+ visits/day and 4.0M annual visits (based on Creditell)

# Westridge Court

Chicago-Naperville-Elgin, IL-IN-WI

41.7653, -88.2027

204 South Route 59 | Naperville, IL 60540



## Available Space

01A	12,765 SF
02	20,000 SF
19	28,366 SF
31	1,200 SF
33	2,400 SF
34	5,154 SF
36	6,000 SF

## Current Retailers

N.A.P. 2	Portillo's	0 SF	Exchange	
	Restaurants	22	Removery	1,350 SF
N.A.P. 1	SuperTarget	0 SF	La Bella Uniforms	1,350 SF
N.A.P. 3	Chili's Grill & Bar	0 SF	PappaRoti	2,700 SF
N.A.P. 4	Arby's	0 SF	Nails 4 U	1,350 SF
N.A.P.5	Portillo's	0 SF	Xi'an Cuisine	3,600 SF
01	The Fresh Market	25,725 SF	Pita Pita	3,240 SF
03	Painted Tree Marketplace	31,479 SF	Mediterranean Grill	
04-06	La-Z-Boy	13,542 SF	Mission BBQ	3,960 SF
07	Sally Beauty	2,000 SF	Hollywood Palm Theater	50,011 SF
08	IVX Health	2,560 SF	Sola Salon Studios	6,407 SF
09	America's Best Contacts & Eyeglasses	2,653 SF	Dick's Sporting Goods	50,000 SF
10/11	Cost Plus World Market	17,900 SF	Discovery Clothing	11,998 SF
12	Miracle-Ear	1,000 SF	Ulta Beauty	15,216 SF
13	LuLu Head Spa	2,000 SF	Bullfrog Spas	9,000 SF
14	Johnson Fitness & Wellness Store	4,000 SF	Edge Fitness	49,994 SF
15	Bath & Body Works	3,600 SF	Funtopia	27,001 SF
16	SAS Shoes	2,400 SF	Bundoo Khan Express	2,000 SF
17	Dry Bar	2,400 SF	Cabinetry Direct	2,000 SF
18	Wayfair Outlet	23,112 SF	LL Flooring	6,284 SF
20	Five Below	12,000 SF		
21	Fox Valley Currency	1,350 SF		